



# SUBMITTAL COVER SHEET

PROJECT NAME \_\_\_\_\_

LOCATION \_\_\_\_\_

ARCHITECT \_\_\_\_\_

ENGINEER \_\_\_\_\_

CONTRACTOR \_\_\_\_\_

SUBMITTED BY \_\_\_\_\_ DATE \_\_\_\_\_

## UNIT SUMMARY

Quantity						
Unit Designation						
Model No.						
Total Cooling						
Sensible Cooling						
Air Ent. Evaporator						
Air Lvg. Evaporator						
Heating Input						
Heating Output						
CFM/ESP						
EER/SEER						
Electrical						
Minimum Ampacity						
Min.-Max. Breaker						
Net Unit Weight						
Accessory						
Catalog Form Number						

### ACCESSORIES:

### NOTES:

# SUBMITTAL SHEET FOR PACKAGE HEAT PUMP UNITS FEATURING NEW INDUSTRY STANDARD R-410A REFRIGERANT

## RQNM- 13-SEER SERIES RQPM- 14-SEER SERIES



Nominal Sizes 2 thru 5 Tons [7-17.6 kW]

JOB NAME \_\_\_\_\_ DATE \_\_\_\_\_  
 CONTRACTOR \_\_\_\_\_ UNIT DESIGNATION \_\_\_\_\_  
 ENGINEER \_\_\_\_\_ MODEL NO. \_\_\_\_\_  
 SUBMITTED FOR  APPROVAL  RECORD LOCATION \_\_\_\_\_  
 SUBMITTED BY \_\_\_\_\_ ORDER NO. \_\_\_\_\_

### UNIT DATA

#### COOLING PERFORMANCE

TOTAL CAPACITY\* ..... MBH  
 SENSIBLE CAPACITY\* ..... MBH  
 OUTDOOR DESIGN TEMP. .... °F [°C] DB/WB  
 TOTAL SUPPLY AIR ..... CFM [L/s]  
 TEMP. OF AIR ENTERING  
 EVAPORATOR COIL..... °F [°C] DB/WB  
 POWER INPUT REQUIREMENT ..... KW  
 SEER RATING.....  
 (\*uses blower motor heat)

#### HEATING PERFORMANCE

GAS HEAT INPUT CAPACITY..... MBH  
 HEAT PUMP HEATING PERFORMANCE  
 CAPACITY @ 47°F ..... MBH  
 CAPACITY @ 17°F ..... MBH  
 COEFFICIENT OF PERFORMANCE  
 @ 47°F..... C.O.P.  
 @ 17°F..... C.O.P.  
 ELECTRIC HEAT CAPACITY ..... KW  
 H.S.P.F. ....

#### SUPPLY AIR BLOWER PERFORMANCE

TOTAL SUPPLY AIR ..... CFM [L/s]  
 TOTAL RESISTANCE EXTERNAL  
 TO UNIT ..... IWG  
 BLOWER SPEED ..... RPM  
 POWER OUTPUT REQUIREMENT .. BHP  
 MOTOR RATING ..... HP [W]  
 POWER INPUT REQUIREMENT ..... KW

#### ELECTRICAL DATA

POWER SUPPLY ..... Hz  
 TOTAL UNIT AMPACITY..... AMPS  
 MINIMUM WIRE SIZE ..... AWG  
 MAXIMUM OVERCURRENT DEVICE  
 FUSES HACR BREAKER ..... AMPS

#### TOTAL UNIT WEIGHT

TOTAL OPERATING WEIGHT .... LBS [kg]  
 (including field-installed accessories)

#### CLEARANCES

SIDE "A"	18" [457 mm]
SIDE "B"	0"
SIDE "C"	12" [305 mm]
SIDE "D"	30" [762 mm]
ABOVE UNIT	60" [1524 mm]

### FEATURES FOR RQNM/RQPM-

- Scroll Compressor
- Copper Tube/Aluminum Fin Coils
- Powder painted louvered steel cabinet protects coil from damage
- Painted Base Pan
- Demand Defrost Control
- Non-Cycling Reversing Valve
- Gauge Ports
- Control box is fully accessible
- Power and control wiring are kept separate
- Certified and rated under ARI Standard 240
- U.L. listed
- Factory run tested prior to shipment
- Factory limited warranty on parts as follows:  
 Compressor  
 1 Phase, Residential Applications.....Ten (10) Years  
 13 & 14 SEER, Commercial Applications.....Five (5) Years  
 Conditional Parts, 1 Phase, Residential Applications  
 (Registration Required) .....Ten (10) Years  
 1 & 3 Phase, Commercial Applications .....One (1) Year

[ ] Designates Metric Conversions



# DIMENSIONS

Model	Height "A"
024, 030, 036, 037	29 1/8"
042, 048, 049, 060	37 1/8"

# FRONT VIEW

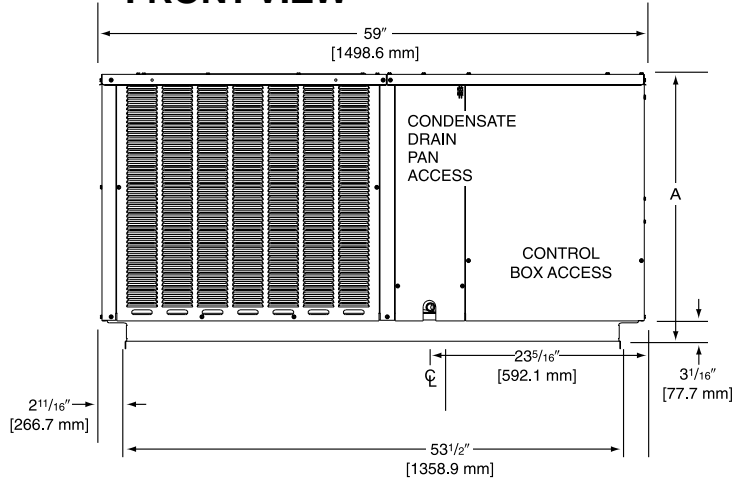

# REAR VIEW

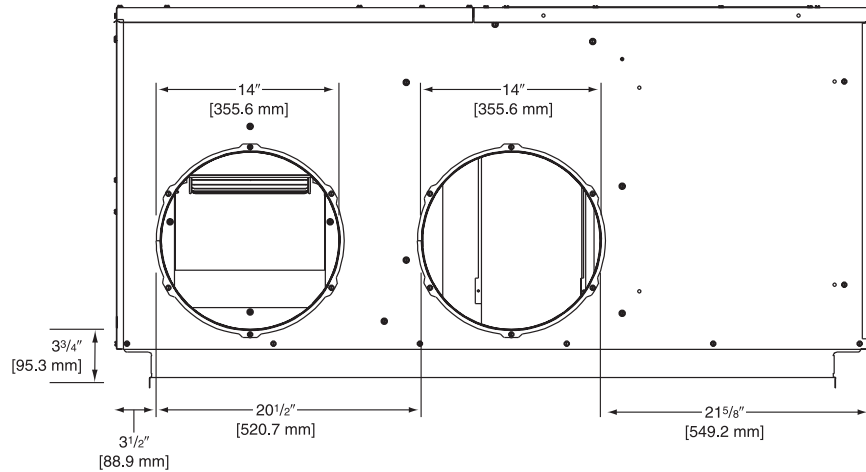

# ELECTRICAL CONNECTIONS

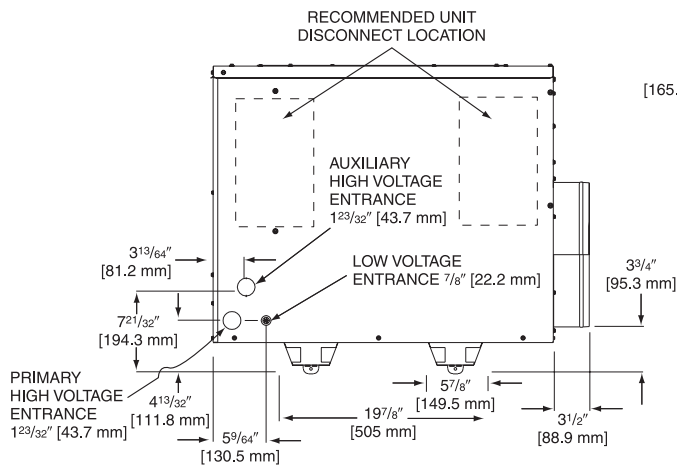

# BOTTOM VIEW

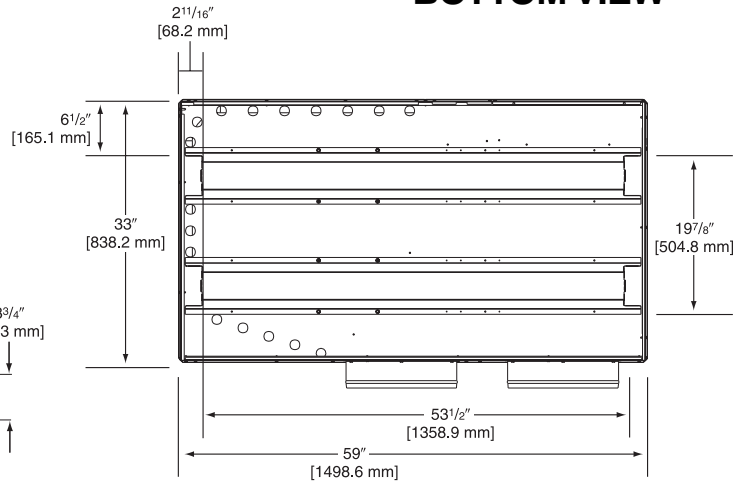

[ ] Designates Metric Conversions

**Before proceeding with installation, refer to installation instructions packaged with each model, as well as complying with all Federal, State, Provincial, and Local codes, regulations, and practices.**

Rheem Sales Company, Inc.  
 P.O. Box 17010, Fort Smith, AR 72917

"In keeping with its policy of continuous progress and product improvement, Rheem reserves the right to make changes without notice."